

# Standard Frequency Vibrodrivers (H & HD series)

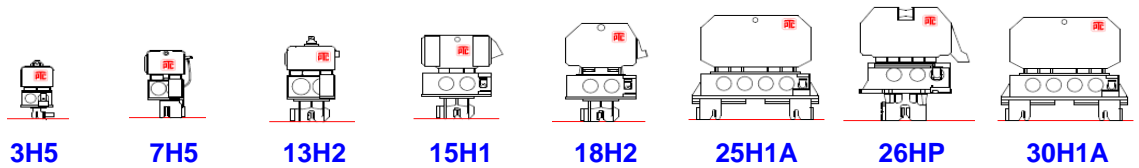

Vibrator		3H5	7H5	13H2	15H1	18H2	25H1A	26HP	30H1A
Power of vibrator	kW/hp	30/41	50/68	110/150	123/167	128/172	153/206	158/215	196/266
Eccentric moment	m.kg	3	6.5	13	15	17	23	25	30
Maximum frequency	Hz/rpm	28/1680	33/1980	28/1680	28/1680	27/1620	29/1740	27/1620	28/1680
Max. centrifugal force	kN	95	285	410	473	498	778	730	946
Max. line pull capacity	kN	140	120	120	200	280	400	500	400
Vibrating weight	kg	305	650	910	1250	1430	2200	1930	2470
Total weight	kg	555	980	1380	2200	2500	3600	3230	4120
Max. amplitude	mm	19.6	20	28.5	24	23.8	21	23	24
Cooler*		-	-	-	-	-	-	option	-
Length	m	0.616	0.980	1.055	1.600	1.590	2.500	2.010	2.500
Max. width	m	0.485	0.590	0.620	0.620	0.620	0.740	0.780	0.740
Centre width	m	0.260	0.330	0.330	0.315	0.330	0.330	0.350	0.330
Height without clamp	m	1.025	1.075	1.410	1.350	1.610	1.800	1.900	1.800

Power Pack		70	85	180	18	220	260	260	350
Type		70	85	180	18	220	260	260	350
Intermittent rating of engine DIN6271 or ISO3046	kW/hp	38/52	60/81	127/173	127/173	138/184	205/279	205/279	242/329
Engine model		CAT 3024 C	J.DEERE 4045 D	J.DEERE 6068 TF275	J.DEERE 6068 TF275	J.DEERE 6068 HF275	CAT C7 ACERT	CAT C7 ACERT	CAT C9 ACERT
Max. rotation speed	r.p.m	2700	2500	2500	2500	2400	2300	2300	2300
Max. oil flow	l/mn	70	85	180	180	240	280	280	370
Max. working pressure	bar	350	385	385	385	365	385	385	385
Hydraulic oil capacity	l	110	125	270	270	270	310	310	310
Fuel capacity	l	90	150	260	260	260	450	450	450
Length	m	2.270	2.400	3.150	3.150	3.150	3.860	3.860	3.860
Width	m	0.950	0.950	1.270	1.270	1.270	1.600	1.600	1.600
Height	m	1.470	1.650	1.865	1.865	1.865	1.900	1.900	1.900
Weight without fuel	kg	1600	1500	3200	3200	3200	4300	4300	4300

Connecting Hoses		20	20	30	30	30	30	30	30
Standard length	m	20	20	30	30	30	30	30	30
Weight	kg	130	130	220	220	220	350	350	350

Clamping Head		Agriplex 22 t	Agriplex 40 t	Agriplex 55 t	Agriplex 55 t	Agriplex 55 t	Agriplex 120 t	Agriplex 120 t	Agriplex 120 t
Single sheet piles not Z, double straight web and Z shaped sheet piles		Weight 72 kg	Weight 220 kg	Weight 360 kg	Weight 360 kg	Weight 360 kg	Weight 750 kg	Weight 750 kg	Weight 750 kg
Double sheet piles not Z shaped		-	Multiplex 2x42 t Weight 850 kg	-	Multiplex 2x42 t Weight 900 kg	Multiplex 2x42 t Weight 900 kg	Multiplex 2x55 t Weight 1300 kg	Multiplex 2x55 t Weight 1300 kg	Multiplex 2x55 t Weight 1300 kg
Casings and most box piles		-	-	-	Duplex 2x42 t Weight 580 kg	Duplex 2x42 t Weight 580 kg	Duplex 2x55 t Weight 950 kg	Duplex 2x55 t Weight 950 kg	Duplex 2x55 t Weight 950 kg



INNOVATION AND DIVERSITY

\* Noticeably for continuous running

# Standard Frequency Vibrodrivers (H & HD series)

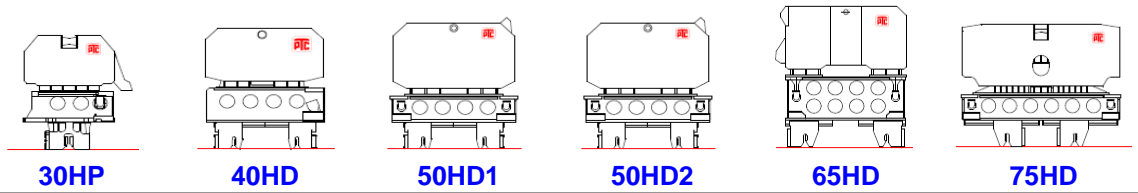

## Vibrator

Power of vibrator	kW/hp	196/266	269/365	255/347	290/394	305/414	410/558
Eccentric moment	m.kg	30	40	45	50	65	75
Maximum frequency	Hz/rpm	27/1620	28/1680	25/1500	25/1500	26/1560	25/1500
Max. centrifugal force	kN	880	1260	1130	1257	1770	1887
Max. line pull capacity	kN	300	500	500	600	600	1050
Vibrating weight	kg	2000	3000	3100	3200	5000	5930
Total weight	kg	3300	6300	6300	6400	7300	11800
Max. amplitude	mm	30	26.5	29	31.2	26	25.3
Cooler*		option	option	option	option	option	option
Length	m	2.110	2.320	2.550	2.550	2.350	3.460
Max. width	m	0.780	0.955	0.680	0.680	0.745	0.780
Centre width	m	0.390	0.380	0.380	0.380	0.330	0.780
Height without clamp	m	1.900	2.060	2.020	2.020	2.500	2.100

## Power Pack

Type		350	450	450	500	600	700
Intermittent rating of engine DIN6271 or ISO3046	kW/hp	242/329	313/426	313/426	354/475	403/548	433/588
Engine model		CAT C9 ACERT	CAT C11 ACERT	CAT C11 ACERT	CAT C13 ACERT	CAT C15 ACERT	CAT C15 ACERT
Max. rotation speed	r.p.m	2300	2300	2300	2300	2300	2300
Max. oil flow	l/mn	370	520	520	520	600	700
Max. working pressure	bar	385	385	350	385	385	385
Hydraulic oil capacity	l	310	390	390	630	720	720
Fuel capacity	l	450	400	400	1000	925	925
Length	m	3.860	4.225	4.225	4.350	4.680	4.680
Width	m	1.600	1.600	1.600	1.640	1.840	1.840
Height	m	1.900	2.070	2.070	2.085	2.340	2.340
Weight without fuel	kg	4300	5000	5000	5500	7000	7000

## Connecting Hoses

Standard length	m	30	45	45	45	45	45
Weight	kg	350	520	520	520	855	855

## Clamping Head

Single sheet piles not Z, double straight web and Z shaped sheet piles	Agriplex 120 t Weight 750 kg	Agriplex 170 t Weight 1250 kg	Agriplex 170 t Weight 1250 kg	Agriplex 170 t Weight 1250 kg	Agriplex 240 t Weight 2150 kg	Agriplex 240 t Weight 2150 kg
Double sheet piles not Z shaped	Multiplex 2x55 t Weight 1300 kg	Multiplex 2x85 t Weight 1650 kg	Multiplex 2x85 t Weight 1650 kg	Multiplex 2x85 t Weight 1650 kg	Multiplex 2x120 t Weight 2200 kg	Multiplex 2x120 t Weight 2200 kg
Casings and most box piles	Duplex 2x55 t Weight 950 kg	Duplex 2x85 t Weight 1250 kg	Duplex 2x85 t Weight 1250 kg	Duplex 2x85 t Weight 1250 kg	Duplex 2x120 t Weight 1630 kg	Duplex 2x120 t Weight 1630 kg



INNOVATION AND DIVERSITY

\* Noticeably for continuous running

# Standard Frequency Vibrodrivers (H & HD series)

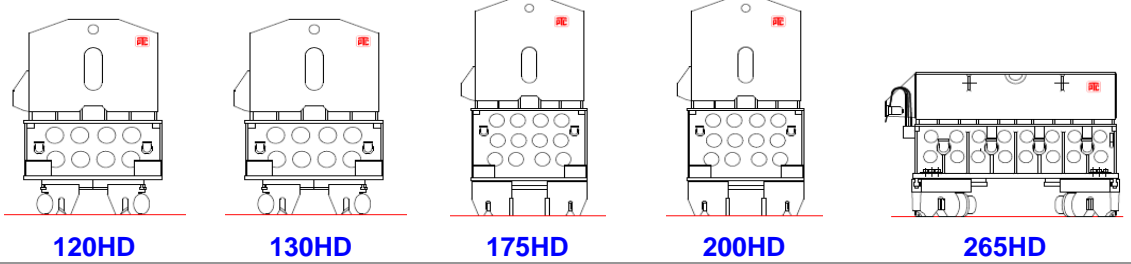

## Vibrator

Power of vibrator	kW/hp	410/613	564/767	611/830	710/966	1080/1470
Eccentric moment	m.kg	120	130	180	199	261
Maximum frequency	Hz/rpm	23/1380	23/1380	23/1380	23/1380	24/1440
Max. centrifugal force	kN	2550	2766	3830	4230	6050
Max. line pull capacity	kN	1200	1200	1800	1800	1800
Vibrating weight	kg	8200	8350	13000	13340	19950
Total weight	kg	13300	13450	19200	19540	27450
Max. amplitude	mm	29.3	31.1	27.7	29.8	26.1
Cooler*		option	option	option	option	option
Length	m	2.300	2.300	2.300	2.300	4.100
Max. width	m	1.505	1.505	1.520	1.520	2.000
Centre width	m	0.800	0.800	0.800	0.800	1.600
Height without clamp	m	3.000	3.000	4.000	4.000	2.300

## Power Pack

Type		800	1000	1200	1200	1900
Intermittent rating of engine DIN6271 or ISO3046	kW/hp	571/776	656/892	783/1065	783/1065	1373/1867
Engine model		CAT C18 ACERT	CAT 3412C DITA	CAT C27 ACERT	CAT C27 ACERT	CAT 3512 B
Max. rotation speed	r.p.m	2100	2100	2100	2100	1850
Max. oil flow	l/mn	820	960	1170	1170	1900
Max. working pressure	bar	385	385	385	385	385
Hydraulic oil capacity	l	815	820	1030	1030	1900
Fuel capacity	l	1100	1100	1650	1650	2400
Length	m	5.000	5.000	5.100	5.100	7.535
Width	m	2.080	2.040	2.240	2.240	2.260
Height	m	2.415	2.275	2.230 (2.630)	2.230 (2.630)	2.280
Weight without fuel	kg	9500	9500	10000	10000	20000

## Connecting Hoses

Standard length	m	45	45	45	45	45
Weight	kg	1030	1030	1670	1670	2200

## Clamping Head

Single sheet piles not Z, double straight web and Z shaped sheet piles	Agriplex 240 t Weight 2150 kg	Agriplex 240 t Weight 2150 kg	Agriplex 2x240 t Weight 5500 kg	Agriplex 2x240 t Weight 5500 kg	-
Double sheet piles not Z shaped	Multiplex 2x150 t Weight 3100 kg	Multiplex 2x150 t Weight 3100 kg	Multiplex 2x250 t Weight 5250 kg	Multiplex 2x250 t Weight 5250 kg	-
Casings and most box piles	Quadriplex 4x120 t Weight 3200 kg Duplex 2x150 t Weight 3100 kg	Quadriplex 4x120 t Weight 3200 kg Duplex 2x150 t Weight 3100 kg	Quadriplex 4x150 t Weight 6200 kg	Quadriplex 4x150 t Weight 6200 kg	Quadriplex 4x250 t Weight 10500 kg



INNOVATION AND DIVERSITY

\* Noticeably for continuous running

# High Frequency Vibrodrivers (HF series)

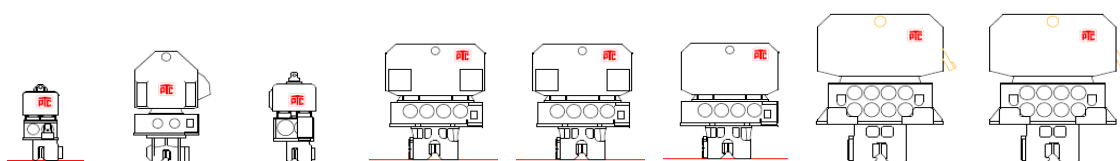

**3HF5      7HF3      7HF4      13HF3      15HF3      20HF3      23HF3A      30HF3A**

## Vibrator

Power of vibrator	kW/hp	44/60	92/125	92/125	153/206	210/285	222/302	230/312	292/397
Eccentric moment	m.kg	3	6.5	6.5	13.5	15	18	23	27
Maximum frequency	Hz/rpm	38/2300	38/2300	38/2300	38/2300	38/2300	38/2300	38/2300	38/2300
Max. centrifugal force	kN	175	380	380	798	887	1060	1360	1596
Max. line pull capacity	kN	140	200	120	300	300	300	400	400
Vibrating weight	kg	305	900	650	1200	1300	1900	2300	2400
Total weight	kg	560	1900	1050	2500	2600	3050	3900	4000
Max. amplitude	mm	19.6	14.4	20	22.5	23	19	20	22.5
Cooler*		-	-	-	-	-	-	-	-
Length	m	0.616	1.320	0.850	1.745	1.745	1.745	2.200	2.200
Max. width	m	0.485	0.580	0.590	0.700	0.700	0.765	0.765	0.765
Centre width	m	0.260	0.320	0.330	0.340	0.340	0.415	0.330	0.330
Height without clamp	m	1.025	1.580	1.300	1.510	1.510	1.647	2.030	2.030

## Power Pack

Type		85	180	180	260	350	350	350	600
Intermittent rating of engine DIN6271 or ISO3046	kW/hp	60/81	127/173	127/173	205/279	242/329	242/329	242/329	403/548
Engine model		J.DEERE 4045D	J.DEERE 6068 TF275	J.DEERE 6068 TF275	CAT C7 ACERT	CAT C9 ACERT	CAT C9 ACERT	CAT C9 ACERT	CAT C15 ACERT
Max. rotation speed	r.p.m	2500	2500	2500	2300	2300	2300	2300	2300
Max. oil flow	l/mn	85	180	180	280	380	380	380	600
Max. working pressure	bar	385	385	385	385	385	385	385	385
Hydraulic oil capacity	l	125	270	270	310	310	310	310	630
Fuel capacity	l	150	260	260	450	450	450	450	1000
Length	m	2400	3.150	3.150	4.000	4.000	4.000	4.000	4.500
Width	m	0.950	1.270	1.270	1.600	1.600	1.600	1.600	1.640
Height	m	1.650	1.865	1.865	2.040	2.040	2.040	2.040	2.085
Weight without fuel	kg	1500	3200	3200	4200	4200	4200	4200	7000

## Connecting Hoses

Standard length	m	15	30	30	30	30	30	30	30
Weight	kg	110	220	220	350	350	350	350	570

## Clamping Head

Single sheet piles not Z, double straight web and Z shaped sheet piles	Agriplex 40 t Weight 220 kg	Agriplex 55 t Weight 360 kg	Agriplex 40 t Weight 220 kg	Agriplex 85 t Weight 430 kg	Agriplex 120 t Weight 750 kg	Agriplex 120 t Weight 750 kg	Agriplex 170 t Weight 1250 kg	Agriplex 240 t Weight 2150 kg
Double sheet piles not Z shaped	-	Multiplex 2x42 t Weight 900 kg	-	Multiplex 2x42 t Weight 980 kg	Multiplex 2x55 t Weight 1300 kg	Multiplex 2x55 t Weight 1300 kg	Multiplex 2x85 t Weight 1650 kg	Multiplex 2x120 t Weight 2200 kg
Casings and most box piles	-	Duplex 2x42 t Weight 580 kg	-	Duplex 2x42 t Weight 590 kg	Duplex 2x55 t Weight 950 kg	Duplex 2x55 t Weight 950 kg	Duplex 2x85 t Weight 1250 kg	Duplex 2x120 t Weight 1660 kg



**INNOVATION AND DIVERSITY**

\* Noticeably for continuous running

# High Frequency with Variable Amplitude Vibrodrivers (HFV series)

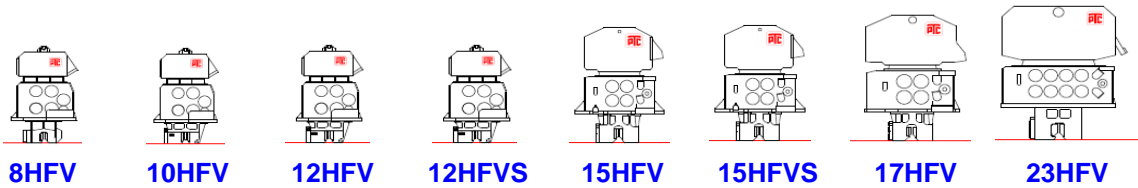

## Vibrator

Power of vibrator	kW/hp	107/145	107/145	125/170	165/224	156/212	200/272	215/292	222/302
Eccentric moment	m.kg	0-8	0-10	0-12	0-12	0-15	0-15	0-17	0-23
Maximum frequency	Hz/rpm	38/2300	38/2300	38/2300	38/2340	38/2300	38/2300	38/2300	38/2300
Max. centrifugal force	kN	473	590	710	710	890	890	1000	1360
Max. line pull capacity	kN	100	100	100	100	300	300	300	400
Vibrating weight	kg	1690	1700	1710	1720	2200	2210	3000	3610
Total weight	kg	2090	2100	2110	2120	3190	3200	4500	5500
Max. amplitude	mm	9.5	11.7	14	14	13.6	13.5	11	13
Cooler*		-	-	-	-	-	-	standard	option
Length	m	1.250	1.250	1.250	1.250	1.780	1.780	1.965	2.200
Max.width	m	0.600	0.600	0.600	0.600	0.780	0.780	0.910	0.860
Centre width	m	0.350	0.350	0.350	0.350	0.340	0.340	0.380	0.340
Height without clamp	m	1.474	1.474	1.474	1.474	1.900	1.900	2.120	2.115

## Power Pack

Type		180	200	220	260	260	350	450	450
Intermittent rating of engine DIN6271 or ISO3046	kW/hp	127/173	138/184	138/184	205/279	205/279	242/329	313/426	313/426
Engine model		J. DEERE 6068 TF275	J. DEERE 6068 HF275	J. DEERE 6068 HF275	CAT C7 ACERT	CAT C7 ACERT	CAT C9 ACERT	CAT C11 ACERT	CAT C11 ACERT
Max. rotation speed	r.p.m	2500	2400	2400	2300	2300	2300	2300	2300
Max. oil flow	l/mn	180	190	230	280	280	400	510	510
Max. working pressure	bar	385	385	360	385	385	385	385	385
Hydraulic oil capacity	l	270	270	270	310	310	310	390	390
Fuel capacity	l	260	260	260	450	450	450	870	870
Length	m	3.150	3.150	3.285	4.000	4.000	4.000	4.225	4.225
Width	m	1.270	1.270	1.270	1.600	1.600	1.600	1.600	1.600
Height	m	1.865	1.865	1.865	1.900	1.900	1.900	2.210	2.210
Weight without fuel	kg	3200	3200	3250	4200	4200	4300	5250	5250

## Connecting Hoses

Standard length	m	30	30	30	30	30	30	30	30
Weight	kg	265	265	265	265	395	395	395	395

## Clamping Head

Single sheet piles not Z, double straight web and Z shaped sheet piles	Agriplex 55 t Weight 360 kg	Agriplex 85 t Weight 430 kg	Agriplex 85 t Weight 430 kg	Agriplex 85 t Weight 430 kg	Agriplex 120 t Weight 750 kg	Agriplex 120 t Weight 750 kg	Agriplex 120 t Weight 750 kg	Agriplex 170 t Weight 1250 kg
Double sheet piles not Z shaped	Multiplex 2x42 t Weight 900 kg	Multiplex 2x42 t Weight 900 kg	Multiplex 2x42 t Weight 900 kg	Multiplex 2x42 t Weight 900 kg	Multiplex 2x55 t Weight 1300 kg	Multiplex 2x55 t Weight 1300 kg	Multiplex 2x55 t Weight 1300 kg	Multiplex 2x85 t Weight 1650 kg
Casings and most box piles	Duplex 2x42 t Weight 590 kg	Duplex 2x42 t Weight 590 kg	Duplex 2x42 t Weight 590 kg	Duplex 2x42 t Weight 590 kg	Duplex 2x55 t Weight 950 kg	Duplex 2x55 t Weight 950 kg	Duplex 2x55 t Weight 950 kg	Duplex 2x85 t Weight 1250 kg



INNOVATION AND DIVERSITY

\* Noticeably for continuous running

# High Frequency with Variable Amplitude Vibrodrivers (HFV series)

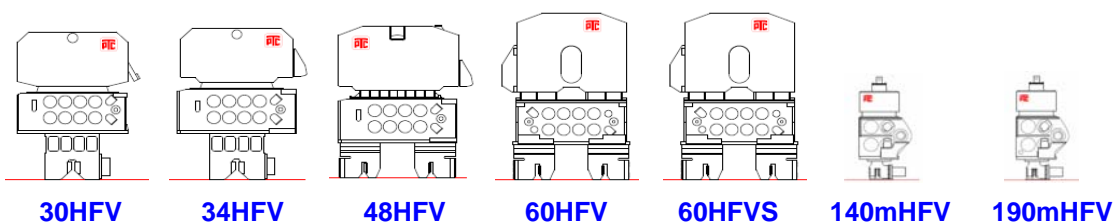

Vibrator		30HFV	34HFV	48HFV	60HFV	60HFVS	140mHFV	190mHFV
Power of vibrator	kW/hp	307/417	405/550	540/734	425/578	662/900	27/37	27/37
Eccentric moment	m.kg	0-27	0-34	0-48	0-54	0-54	0-1.4	0-1.9
Maximum frequency	Hz/rpm	38/2300	38/2300	37/2200	38/2300	38/2300	45/2700	45/2700
Max. centrifugal force	kN	1596	2010	2640	3190	3190	114	155
Max. line pull capacity	kN	400	400	530	600	600	50	50
Vibrating weight	kg	3770	5000	5700	6360	6360	405	415
Total weight	kg	5600	7000	8000	11200	11200	540	550
Max. amplitude	mm	14.3	13.6	17	17	17	6.9	9.1
Cooler*		option	standard	option	option	option	-	-
Length	m	2.200	2.320	2.350	2.280	2.280	0.680	0.680
Max. width	m	0.860	0.860	1.120	1.400	1.400	0.548	0.548
Centre width	m	0.340	0.380	0.530	0.840	0.840	0.285	0.285
Height without clamp	m	2.115	2.255	2.490	2.830	2.830	1.098	1.098

Power Pack		600	700	1000	800	1200	70	70
Type								
Intermittent rating of engine DIN6271 or ISO3046	kW/hp	403/548	433/588	656/892	571/776	783/1065	38/52	38/52
Engine model		CAT C15 ACERT	CAT C15 ACERT	CAT 3412C DITA	CAT C18 ACERT	CAT C27 ACERT	CAT 3024 C	CAT 3024 C
Max. rotation speed	r.p.m	2300	2300	2100	2100	2100	2700	2700
Max. oil flow	l/mn	600	680	960	820	1170	55	55
Max. working pressure	bar	385	385	385	385	385	350	350
Hydraulic oil capacity	l	720	720	820	820	1030	110	110
Fuel capacity	l	925	925	1100	1100	1650	90	90
Length	m	4.680	4.680	5.000	5.000	5.100	2.270	2.270
Width	m	1.840	1.840	2.040	2.040	2.240	0.950	0.950
Height	m	2.340	2.340	2.000	2.000	2.230	1.470	1.470
Weight without fuel	kg	7000	7000	9500	9500	10000	1600	1600

Connecting Hoses		30	45	45	45	45	15	15
Standard length	m							
Weight	kg	615	1200	1200	1095	1670	110	110

Clamping Head		Agriplex 240 t	Agriplex 240 t	Agriplex 240 t	Double Agriplex 2x240 t	Double Agriplex 2x240 t	Agriplex 22 t	Agriplex 22 t
Single sheet piles not Z, double straight web and Z shaped sheet piles		Weight 2150 kg	Weight 2150 kg	Weight 2150 kg	Weight 5500 kg	Weight 5500 kg	Weight 72 kg	Weight 72 kg
Double sheet piles not Z shaped		Multiplex 2x120 t Weight 2200 kg	Multiplex 2x120 t Weight 2200 kg	Multiplex 2x150 t Weight 3100 kg	Multiplex 2x120 t Weight 3100 kg	Multiplex 2x120 t Weight 3100 kg	-	-
Casings and most box piles		Duplex 2x120 t Weight 1660 kg	Duplex 2x120 t Weight 1660 kg	Duplex 2x150 t Weight 3100 kg	Duplex 2x150 t Weight 3100 kg	Duplex 2x150 t Weight 3100 kg	-	-



**INNOVATION AND DIVERSITY**

\* Noticeably for continuous running

# Standard Frequency with Variable Amplitude Vibrodrivers (HV series)

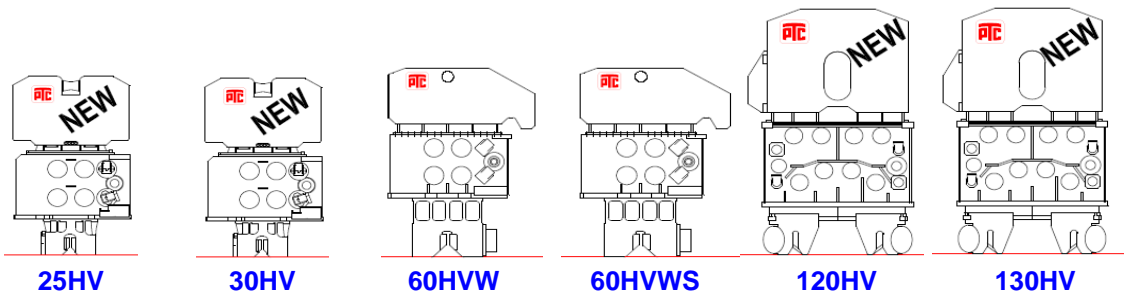

## Vibrator

Power of vibrator	kW/hp	173/235	230/312	330/449	378/514	451/613	564/767
Eccentric moment	m.kg	0-23.5	0-30	0-60	0-60	0-120	0-130
Maximum frequency	Hz/rpm	28/1680	28/1680	28/1680	28/1680	23/1380	23/1380
Max. centrifugal force	kN	740	946	1890	1890	2550	2550
Max. line pull capacity	kN	260	320	600	600	1200	1200
Vibrating weight	kg	2850	2900	6350	6350	9500	9700
Total weight	kg	4350	4400	8200	8200	14250	14450
Max. amplitude	mm	16.5	21	19	19	25.3	26.8
Cooler*		option	option	option	option	Option	Option
Length	m	1.800	1.800	2.220	2.220	2.300	2.300
Max. width	m	0.875	0.875	1.090	1.090	1.505	1.505
Centre width	m	0.340	0.340	0.800	0.800	0.800	0.800
Height without clamp	m	2.400	2.400	2.125	2.125	3.260	3.260

## Power Pack

Type		260	350	600	700	800	1000
Intermittent rating of engine DIN6271 or ISO3046	kW/hp	205/279	242/329	403/548	433/588	571/776	656/892
Engine model		CAT C7 ACERT	CAT C9 ACERT	CAT C15 ACERT	CAT C15 ACERT	CAT C18 ACERT	CAT 3412C DITA
Max. rotation speed	r.p.m	2300	2300	2300	2300	2100	2100
Max. oil flow	l/mn	280	400	600	680	820	960
Max. working pressure	bar	385	385	385	385	385	385
Hydraulic oil capacity	l	310	310	630	720	815	820
Fuel capacity	l	450	450	1000	925	1100	1100
Length	m	4.000	4.000	4.500	4.680	5.000	5.000
Width	m	1.600	1.600	1.640	1.840	2.080	2.040
Height	m	2.040	2.040	2.085	2.340	2.415	2.000
Weight without fuel	kg	4000	4200	7000	7000	9000	9500

## Connecting Hoses

Standard length	m	30	30	30	30	45	45
Weight	kg	395	395	615	615	1050	1050

## Clamping Head

Single sheet piles not Z, double straight web and Z shaped sheet piles	Agriplex 120 t Weight 750 kg	Agriplex 120 t Weight 750 kg	Agriplex 240 t Weight 2150 kg	Agriplex 240 t Weight 2150 kg	Agriplex 240 t Weight 2150 kg	Agriplex 240 t Weight 2150 kg
Double sheet piles not Z shaped	Multiplex 2x55 t Weight 1300 kg	Multiplex 2x55 t Weight 1300 kg	Multiplex 2x120 t Weight 2200 kg	Multiplex 2x120 t Weight 2200 kg	Multiplex 2x150 t Weight 3100 kg	Multiplex 2x150 t Weight 3100 kg
Casings and most box piles	Duplex 2x55 t Weight 950 kg	Duplex 2x55 t Weight 950 kg	Duplex 2x120 t Weight 1660 kg	Duplex 2x120 t Weight 1660 kg	Quadriplex 4x120 t Weight 3200 kg Duplex 2x150 t Weight 3100 kg	Quadriplex 4x120 t Weight 3200 kg Duplex 2x150 t Weight 3100 kg



INNOVATION AND DIVERSITY

\* Noticeably for continuous running

## Vibrodrivers Mounted on Hydraulic Excavators (PHF type)

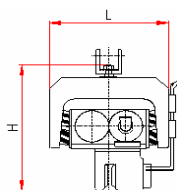

PHF Type  
Compact Yoke

		1PHF1	3PHF3	7PHF4	10PHF5	13PHF2
<b>Vibrator</b>						
Eccentric moment	m.kg	0.7	3	6.5	10	13
Maximum frequency	Hz/rpm	50/3000	45/2700	38/2300	35/2100	28/1680
Max. centrifugal force	kN	70	244	385	493	410
Max. line pull / push capacity	kN	3	6	12	12	12
Max. amplitude	mm	6	12	21.5	22	21
Total weight with clamp	kg	340	980	1290	1960	1860
Length L	m	0.480	1.040	1.040	1.280	1.280
Max. width	m	0.430	0.480	0.610	0.630	0.670
Centre width	m	0.200	0.380	0.380	0.380	0.380
Height without clamp: H	m	0.705	0.705	1.000	0.865	0.865
Hydraulic power	kW	10-54	40-60	105	105	105
Max. working pressure	bar	350	350	350	350	350
Hydraulic flow range	l/mn	15-90	70-140	180-380	180-380	180-380
<b>Clamping Head</b>						
Single sheet piles		Agriplex 20 t	Agriplex 20 t / 40 t	Agriplex 40 t	Agriplex 55 t	Agriplex 55 t

## Vibrodrivers Mounted on Hydraulic Excavators (HF type)

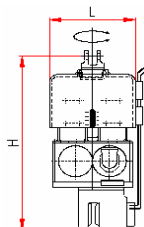

HF Type  
Slim Yoke

		1HF1	3HF3	7HF4	10HF5	13H2
<b>Vibrator</b>						
Eccentric moment	m.kg	0.7	3	6.5	10	13
Maximum frequency	Hz/rpm	50/3000	45/2700	38/2300	35/2100	28/1680
Max. centrifugal force	kN	70	244	385	493	410
Max. line pull / push capacity	kN	3	6	12	12	12
Max. amplitude	mm	6	11	20	22	28.5
Total weight with clamp	kg	340	940	1420	1940	1740
Length L	m	0.480	0.700	0.865	0.940	0.940
Max. width	m	0.430	0.480	0.590	0.620	0.620
Centre width	m	0.200	0.290	0.330	0.330	0.330
Height without clamp: H	m	0.975	1.325	1.300	1.410	1.410
Hydraulic power	kW	oct-54	40-60	105	105	105
Max. working pressure	bar	350	350	350	350	350
Hydraulic flow range	l/mn	15-90	70-140	180-380	180-380	180-380
<b>Clamping Head</b>						
Single sheet piles		Agriplex 20 t	Agriplex 20 t / 40 t	Agriplex 40 t	Agriplex 55 t	Agriplex 55 t

